

*PULSE*DIVE 

# USER MANUAL



FC CE    
FCC ID: 2AJJ2-POINTER

**Nokta**  
DETECTION TECHNOLOGIES

 **Authorized  
R&D CENTER**

## READ CAREFULLY BEFORE OPERATION OF THE DEVICE

### WARNINGS

The PulseDive is a state-of-the-art electronic device. Do not operate the device before reading the user manual.

Do not store the device and search coil under extremely low or high temperatures for extended periods. (Storage Temperature: - 20°C to 60°C / - 4°F to 140°F)

The device has been designed with IP68 rating as a waterproof unit up to 60 meters (200ft.). However, you must pay attention to the warnings below:

1. Do not wash or immerse the coils in water when they are not mounted on the device!

2. Each time before submerging the device in water or before washing it, make sure that:

a. One of the coils is attached correctly and securely. You cannot change the coils underwater!

b. The coil o-ring is placed snugly.

c. The o-ring inside the battery compartment cover is placed snugly and the cover is secured tightly.

3. The PulseDive comes with 2 battery compartment covers. While using the device in dive mode, use the battery compartment cover that comes attached to the device and while using the device on land, use the one that is designed for land use to obtain a louder volume. To prevent the filter, which is used on the cover for land use, from any damage, do not insert any sharp objects into the holes for cleaning or any other purposes.

4. When using the PulseDive in sand, the dust protection cap must be attached to the other coil that is not mounted on the device! If sand is stuck on the o-ring, brush the sand off.

Pay attention to the items below after using the device especially under salty water:

1. Make sure that one of the coils and the battery compartment cover are attached and wash the device with tap water.

2. Do not use any chemicals for cleaning and/or for any other purposes.

Protect the detector against impacts during normal use. For shipping, carefully place detector in original carton and secure with shock resistant packaging.

The PulseDive may only be disassembled and repaired by Nokta Authorized Service Centers. Unauthorized disassembly/intrusion into the metal detector control housing for any reason voids the warranty.

## INTRODUCTION TO THE DEVICE

The PulseDive can be purchased in 2 models: Scuba Detector & Pointer 2-in-1 Set and as a stand-alone Pinpointer only. Both models have the same functions and operate the same way. The only difference between them is the scuba coil and some accessories included in the 2-in-1 set. If you bought the stand-alone pinpointer, please disregard the instructions about the scuba coil in the assembly section. You can purchase the scuba coil separately to add that functionality at anytime.

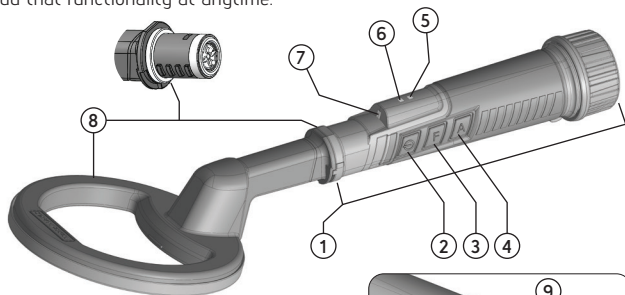

- 1) Control Unit
- 2) On-Off and Retune Button
- 3) F - Function Button
- 4) A - Adjustment Button
- 5) Green LED
- 6) Red LED
- 7) LED Flashlight
- 8) Scuba Coil & Washer (white)
- 9) Charging Port
- 10) Speaker
- 11) Battery Compartment Cover
- 12) Battery Compartment Cover (for land use)
- 13) Pointer Coil & Washer (black)
- 14) Dust Protection Cap
- 15) Replaceable Hard-Shell Pointer Case

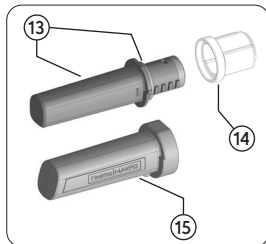
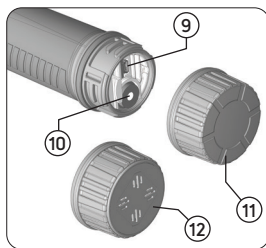

## ASSEMBLY

The PulseDive comes with the scuba coil attached. If you want to use the pinpointer coil, please follow the steps in the pictures. If you want to re-attach the scuba coil, repeat the steps in reverse order.

**IMPORTANT!** When changing coils, align the plastic tab on the control unit with the opposing groove on the coil and twist clockwise to secure.

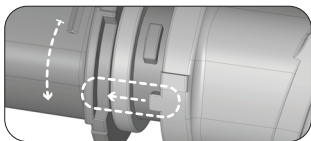

- 1) To detach the scuba coil, turn it counter clockwise.
- 2) Pull the scuba coil out of the control unit.

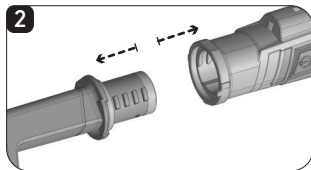
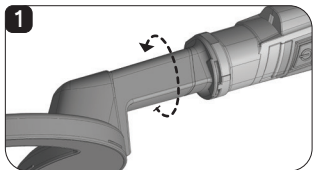

**IMPORTANT!** Do not hold the scuba coil cover from its front end while removing it. Hold it from the rear end as shown in the picture below to avoid breaking the coil.

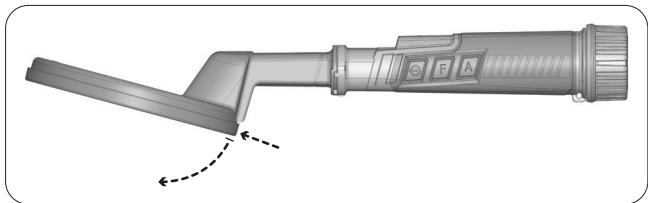

## ASSEMBLY

3) Hold the pinpointer coil so that the threads are properly aligned.

4) Insert the pinpointer coil into the control unit and push.

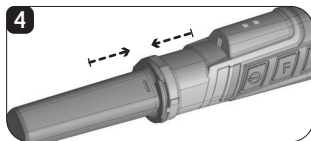
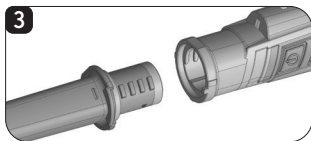

5) To attach the pinpointer coil, insert the hard-shell case over the pointer coil and push half-way forward.

6) Then, twist the coil clockwise to tighten. Lastly, push the hard-shell case all the way so it clicks into place.

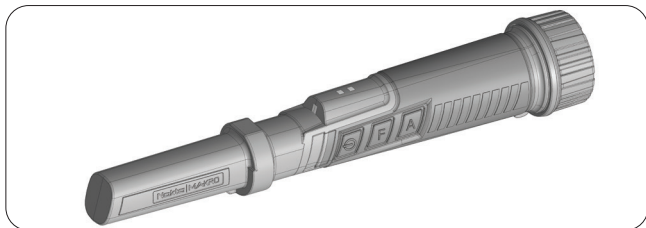
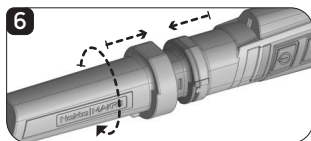
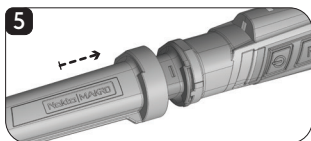

**IMPORTANT!** The pinpointer coil is designed to fit very tightly to provide a waterproof seal. When you want to detach or attach the pointer coil, insert the hard-shell case over the pointer coil half-way and twist the pointer coil with the help of the hard-shell case.

**IMPORTANT!** You must not detach and/or change the scuba or the pinpointer coil underwater!

## ASSEMBLY

**WARNING:** If you change the coil while the device is on, you must retune the device by pressing the on-off / retune button once.

In order to not lose the PulseDive while using it underwater or on land, we recommend you to attach the security lanyard as shown in the below picture.

**7)** Attach one end (a) of the security lanyard to the hole located at the back of the control unit and the other end with the snap hook (b) to your belt or wrist band.

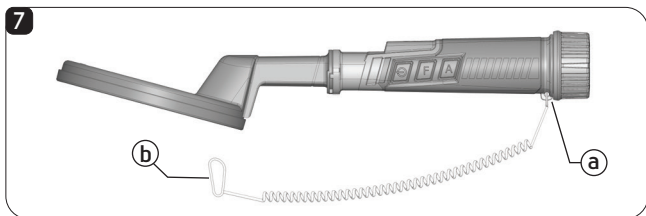

In order to carry the PulseDive on your waist and not to lose it, we recommend you to use the belt holster and the security lanyard as shown in the below picture.

**8)** Attach one end (a) of the security lanyard to the hole located at the back of the control unit and the other end with the snap hook (b) to the belt holster loop.

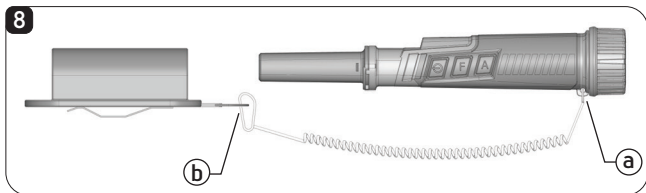

## BATTERY INFORMATION

The PulseDive has an internal 1650mAh Lithium Polymer battery. Charge the PulseDive before initial use. Charging will take approximately 2 hours.

### Charging

You can charge the device with a USB charger, a powerbank, on a PC or in your car using the included charging cable.

\* The charging time may be longer for USB chargers rated less than 1 Amp or older type of PCs.

While charging, the red LED will light up solid. When the battery is full, the green and red LEDs will light up together. If there is any problem during charging, the green LED will start blinking.

### Battery Indicators

At start up:

Red and green LEDs blink once: Battery is full

Green LED blinks once: Battery is half full

Red LED blinks once: Battery is empty

When the batteries are completely depleted, the red and green LEDs light up every 5 seconds. For a short period of time, the device will continue to work and then it will emit a single beep and shut down.

### Battery Warnings

**IMPORTANT! The device does not work while charging.**

Do not expose the device to extreme temperatures (for example a car's trunk or glove compartment)

Do not charge the battery in temperatures over 35° C (95° F) or below 0° C (32° F).

The PulseDive battery can only be replaced by **Nokta Detectors** or its authorized service centers.

## OPERATION OF THE DEVICE

During the operation of the PulseDive, the Green LED blinks once when you press any button. It lights up solid when the buttons are pressed down and held.

### POWER ON-OFF

Press the on-off button once to turn the device on. A beep will be heard and the LEDs will light up according to the battery life status. To turn the device off, press and hold the on-off button. Double beeps will be heard, regardless of the mode used, and both LEDs will light up simultaneously.

The device automatically retunes itself when it is turned on. Therefore, keep the device away from metal objects while powering it on. If you are going to use the device on wet beach sand or on highly mineralized ground, it is recommended to turn the device on by placing the search coil on the ground or to turn the device and retune it over the ground. Although this results in a slight loss of depth, it provides a more stable operation.

You can also retune your device instantly when the device emits false signals. In order to retune the device, press the on-off button once. Do not retune the device over metal objects. Otherwise, the device will experience loss of depth.

When the device is turned off and on, it will start with the last saved settings.

### DETECTION MODES

The device has 3 detection modes: Audio, vibration, audio and vibration.

Press the (F) button to change the mode.

#### Red LED

In addition to the above detection modes, PulseDive also has a red LED that indicates metal detection.

When the red LED is activated, it flashes once upon metal detection regardless of the mode used. As you get closer to the target, it flashes faster and more frequently.

To turn on / off the red LED, press and hold the adjustment button (A).

### SENSITIVITY

There are 5 levels of sensitivity. To adjust the sensitivity, press the adjustment button (A) while holding the function button (F) pressed down. Each time you press the A button, the sensitivity increases 1 level. Each level is indicated by a number of beeps and/or vibrations depending on the mode used. For example



## OPERATION OF THE DEVICE

level 4 is indicated by 4 beeps and/or vibrations. At maximum sensitivity –level 5– the device emits a long beep and/or vibration. If the red LED is active, it lights up solid.

Inside highly mineralized holes, the device may produce false signals. In such a case, reduce the sensitivity.

### LED FLASHLIGHT

To activate flashlight, press the adjustment button (A) once while the device is on. Press it again to turn off.

### DIVE MODE

If you are diving with the PulseDive, you need to switch the device to dive mode in order to prevent the buttons from being pressed by water pressure. While in the dive mode, the buttons are locked and do not work. Therefore, make sure that the device is set to the desired settings before switching to dive mode. Recommended settings are vibration and the red LED to be on.

Hold the device upside down (LEDs facing down) as shown in the picture and press the (A) and (F) button simultaneously. The green LED will light up and a beep will be heard and/or the device will vibrate depending on the mode used. If the red LED is on, it will also blink once.

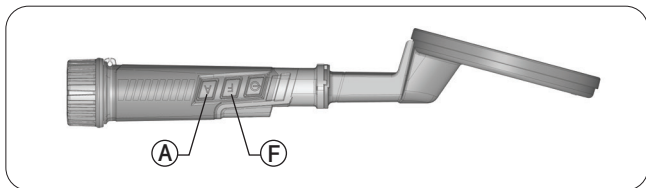

In dive mode, the device will not detect any targets while you hold it upside down. It will detect targets when you flip and hold it the right way.

Repeat the steps above to exit the dive mode. When exiting the dive mode, only a beep will be heard and/or the device will vibrate depending on the mode used; the green LED will not light up. If the red LED is on, it will also blink once.

**IMPORTANT!** The PulseDive will not switch to dive mode while detecting metal!

**NOTE:** The wireless headphones will not work if the device is switched to dive mode while it is connected the wireless headphones. The wireless headphones will connect automatically once the device exits the dive mode.

## OPERATION OF THE DEVICE

**IMPORTANT!** The PulseDive comes with 2 battery compartment covers. While using the device in dive mode, use the battery compartment cover that comes attached to the device and while using the device on land, use the one that is designed for land use to obtain a louder volume. The cover for land use is waterproof and can be washed. However, it cannot be used for diving. To prevent the filter, which is used on the cover for land use, from any damage, do not insert any sharp objects into the holes for cleaning or any other purposes.

### LOST ALARM

The PulseDive has a lost alarm feature which makes it easier to find the device in case you lose it. If no button is pressed and/or if the device does not detect any targets for 5 minutes, the lost alarm is activated. The device starts emitting beeps at short intervals and the LED flashlight starts flashing.

When the lost alarm gets activated while the device is connected to the wireless headphones, the audio is heard through the device and not through the headphones anymore.

### FREQUENCY SHIFT

It is used to prevent the device from interfering with other detectors nearby.

To shift the frequency, press the on-off button while holding the **(F)** button pressed down. Each time you press the on-off button, a beep will be heard and/or the device will vibrate and the frequency will shift 1 step. There are 40 steps in frequency shift. The central frequency, which is the factory default, is indicated by double beeps / vibrations.

### WIRELESS HEADPHONES CONNECTION

PulseDive has an internal wireless connection module for wireless headphones use.

To activate the wireless connection, turn the device on while holding the **(F)** button pressed. The green LED will start flashing at certain intervals to indicate that the wireless module is on.

To turn the wireless connection off, power off the device while holding the **(F)** button pressed.

The pairing instructions can be found in the **Nokta 2.4GHz Wireless Headphones** which are sold separately.

**IMPORTANT!** If the wireless connection is on but the device is not connected to the wireless headphones, the device will do a channel search and the the green LED will light up for almost 5 seconds at start up. During this period, the device will NOT detect metal!

## TECHNICAL SPECIFICATIONS

Operating Principle	: Pulse Induction
Operating Frequency	: 3kHz
Frequency Shift	: Yes
Waterproofness	: IP68 – Up to 60m. (200ft.)
Built-in Wireless Module	: Yes
Detection Modes	: Audio / Vibration / Audio + Vibration / LED
Sensitivity	: 5 levels adjustable
Length	: <b>Scuba Detector</b> : 39cm. (15.3") : <b>Pinpointer</b> : 28cm. (11")
Weight	: <b>Scuba Detector</b> : 419gr. (14.8oz) including the coil cover : <b>Pinpointer</b> : 286 gr. (10oz) including the hard-shell case
Battery	: 1650mAh Lithium Polymer
Charging Time	: ~ 2 hours
Warranty	: 2 years

**Nokta Detectors** reserves the right to change the design, specifications or accessories without notice and without any obligation or liability whatsoever.

### WARRANTY

This product has a 2 year limited warranty from the time of purchase. Please refer to [www.noktadetectors.com](http://www.noktadetectors.com) for further warranty information.



### IMPORTANT

For Consumers within the European Union: Do not dispose of this equipment in general household waste. The crossed wheeled bin symbol on this equipment indicates this unit should not be disposed of in general household waste, but recycled in compliance with local government regulations and environmental requirements.



KKPDS-EN-55000347

**Nokta**  
DETECTION TECHNOLOGIES

[www.noktadetectors.com](http://www.noktadetectors.com)